

## Metered Dispensing Valve

309583D

**For metered dispense of petroleum and synthetic oils.**

*1000 psi (7 MPa, 69 bar) Maximum Working Pressure*

*4 gpm (15.1 lpm) Maximum Flow Rate*

**Model 256556 (1–16 quarts) Flex Extension**

**Model 256786 (1–16 quarts) Rigid Extension**

**Model 256787 (1–16 quarts) Gear Lube Extension**

**Model 253601 (1–10 liters) Flex Extension**

**Model 256788 (1–10 liters) Rigid Extension**

**Model 256789 (1–10 liters) Gear Lube Extension**



**Important Safety Instructions.**

Read all warnings and instructions in this manual.  
Save these instructions.

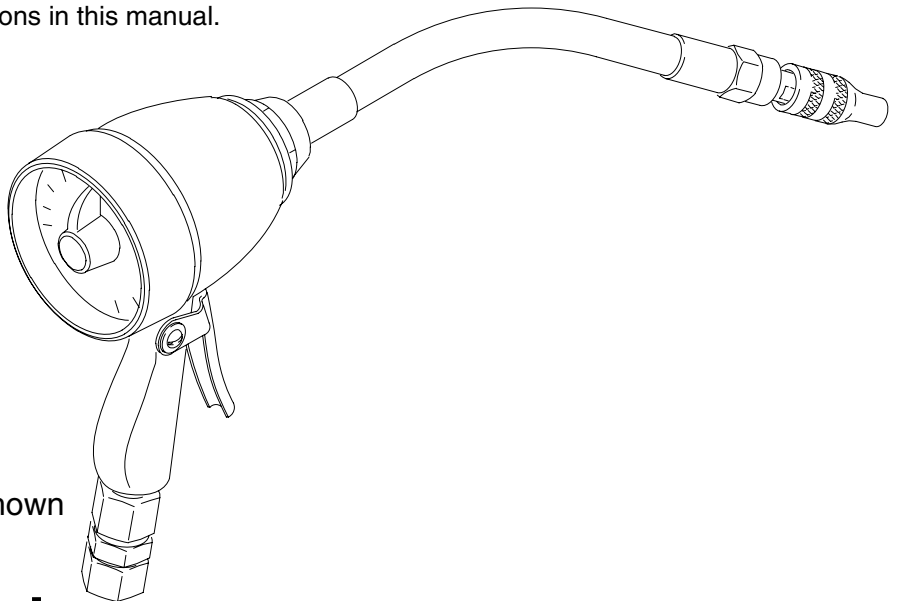

256556 Shown

## Table of Contents

Symbols and Warnings . . . . .	2
Operation . . . . .	3
Service . . . . .	4
Parts . . . . .	5
Dimensions . . . . .	5
Graco Warranty . . . . .	6
Graco Information . . . . .	6

# Symbols

## Warning Symbol







This symbol alerts you to the possibility of serious injury or death if you do not follow the instructions.

## Caution Symbol



This symbol alerts you to the possibility of damage to or destruction of equipment if you do not follow the instructions.

 <b>WARNING</b>	
 <small>INSTRUCTIONS</small>	<p><b>EQUIPMENT MISUSE HAZARD</b></p> <p>Equipment misuse can cause the equipment to rupture or malfunction and result in serious injury.</p> <ul style="list-style-type: none"> <li>● This equipment is for professional use only.</li> <li>● Read all instruction manuals, tags, and labels before operating the equipment.</li> <li>● Use the equipment only for its intended purpose. If you are not sure, call Graco Technical Assistance at 1-800-533-9655.</li> <li>● Do not alter or modify this equipment.</li> <li>● These valves have a 1000 psi (70 bar) <b>Maximum Working Pressure</b> rating. Do not exceed the maximum working pressure of the lowest rated system component.</li> <li>● Comply with all applicable local, state, and national fire, electrical, and safety regulations.</li> </ul>
  	<p><b>SKIN INJECTION HAZARD</b></p> <p>Spray from the dispensing valve, leaks or ruptured components can inject fluid into your body and cause extremely serious injury, including the need for amputation. Fluid splashed in the eyes or on the skin can also cause serious injury.</p> <ul style="list-style-type: none"> <li>● Fluid injected into the skin may look like just a cut, but it is a serious injury. <b>Get immediate surgical treatment.</b></li> <li>● Do not point the dispensing valve at anyone or at any part of the body.</li> <li>● Do not put your hand or fingers over the end of the dispensing valve.</li> <li>● Do not stop or deflect leaks with your hand, body, glove or rag.</li> <li>● Follow the <b>Pressure Relief Procedure</b> below before cleaning, checking or servicing the equipment.</li> <li>● Check the hoses, tubes, and couplings daily. Replace worn or damaged parts immediately. Do not repair high pressure couplings; you must replace the entire hose.</li> </ul>

# Operation

## Pressure Relief Procedure

**⚠ WARNING**

**PRESSURIZED EQUIPMENT HAZARD**

The equipment stays pressurized until pressure is manually relieved. To reduce the risk of serious injury from pressurized fluid, accidental spray from the dispenser or splashing fluid, follow the **Pressure Relief Procedure** whenever you

- are instructed to relieve pressure
- check, clean, or service any system equipment
- install or clean fluid nozzles

1. Turn off the power supply to the pump.
2. Trigger the valve into a waste container to relieve pressure.
3. Open any bleed-type master air valves and fluid drain valves in the system.
4. Leave the drain valve open until you have completed repairs and are ready to pressurize the system.

## Manual Shutoff Valve

The totalizer keeps a running total of the amounts dispensed.

**NOTE:** Clean inlet screen regularly

1. Insert the nozzle into the fluid receptacle and pull the trigger.
2. Watch the meter pointer on the meter dial move, and release the trigger when the desired amount of fluid has been dispensed. The totalizer records the amount dispensed.
3. Return the meter pointer to “O” before dispensing again. See Fig. 1

**⚠ CAUTION**

To avoid costly meter damage, never turn the pointer backwards.

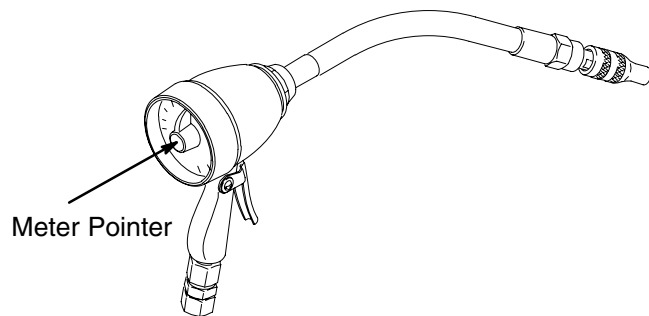

**Fig 1**

T12347

# Service

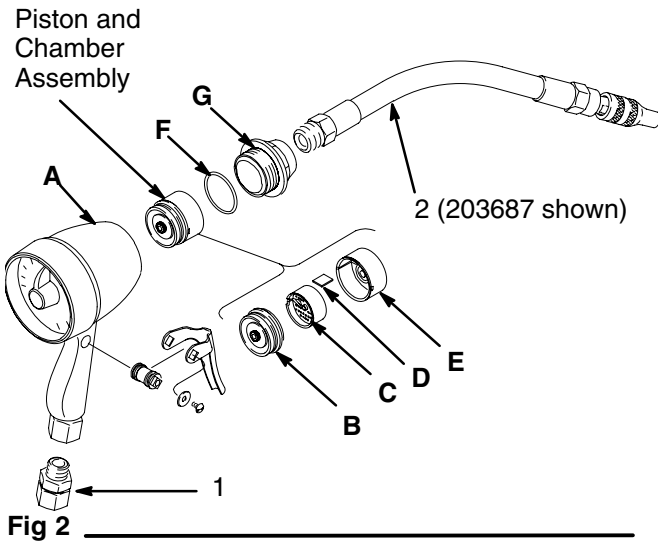

## To clean the meter

1. Screw the meter cap (G) out of the housing (A). Remove the o-ring (F), piston and chamber assembly, and the planet gear. See Fig 2.
2. Insert a screwdriver into the notch of the chamber assembly and pry off the chamber top (B). See Fig 3. Remove all parts.
3. Clean the parts and blow them dry.
4. Reassemble the meter. Insert the piston chamber so the slot (E) straddles the partition plate (D). Install the top chamber (B) and turn the small gear until the piston (C) engages with the pawl. Place the piston and chamber assembly into the housing and turn it to be sure the gears mesh. With the o-ring (F) in place, tighten the cap (G) firmly into the housing (A).

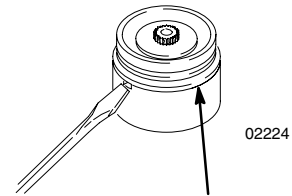

# Parts

## Nozzle Assemblies

203687  
Flexible Extension

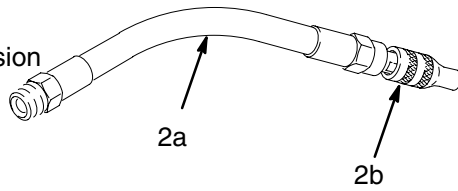

203265  
Rigid Extension

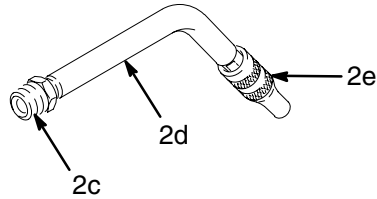

256895  
Gear Lube

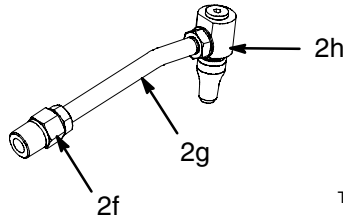

REF NO.	PART NO.	DESCRIPTION	QTY
1	117675	SWIVEL, 1/2 bsp(m) x 1/2 npt(f) (see Fig. 2 on page 4)	1
2		NOZZLE ASSEMBLY (varies by model number)	1
	<b>203687</b>	<b>NOZZLE ASSEMBLY; flexible extension</b> <i>For models 256556 and 253601</i> (includes items 2a–2b)	
2a	109160	. HOSE, coupled; 1 ft (0.3 m); 1/2 npt(m) x 1/4 npt(f)	1
2b	203655	. NOZZLE, non-drip	1
	<b>203265</b>	<b>NOZZLE ASSEMBLY, rigid extension</b> <i>For models 256786 and 256788</i> (includes items 2c–2e)	
2c	100081	. BUSHING; 1/2 npt(m) x 3/8 npt(f)	1
2d	159246	. TUBE, nozzle	1
2e	203655	. NOZZLE, non-drip	1
	<b>256895</b>	<b>NOZZLE ASSEMBLY, gear lube</b> <i>For models 256787 and 256789</i> (includes items 2f–2h)	
2f	15V528	. ADAPTER, 1/2 npt(m) x 1/2 unf orb	1
2g	255754	. EXTENSION, nozzle	1
2h	255470	. NOZZLE, gear lube	1

## Dimensions

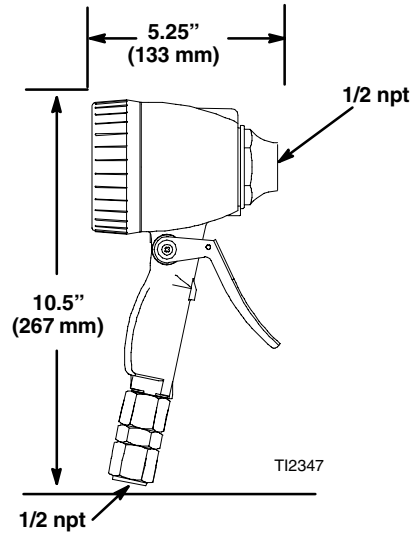

# Graco Standard Warranty

Graco warrants all equipment manufactured by Graco and bearing its name to be free from defects in material and workmanship on the date of sale to the original purchaser for use. With the exception of any special, extended, or limited warranty published by Graco, Graco will, for a period of twelve months from the date of sale, repair or replace any part of the equipment determined by Graco to be defective. This warranty applies only when the equipment is installed, operated and maintained in accordance with Graco's written recommendations.

This warranty does not cover, and Graco shall not be liable for general wear and tear, or any malfunction, damage or wear caused by faulty installation, misapplication, abrasion, corrosion, inadequate or improper maintenance, negligence, accident, tampering, or substitution of non-Graco component parts. Nor shall Graco be liable for malfunction, damage or wear caused by the incompatibility of Graco equipment with structures, accessories, equipment or materials not supplied by Graco, or the improper design, manufacture, installation, operation or maintenance of structures, accessories, equipment or materials not supplied by Graco.

This warranty is conditioned upon the prepaid return of the equipment claimed to be defective to an authorized Graco distributor for verification of the claimed defect. If the claimed defect is verified, Graco will repair or replace free of charge any defective parts. The equipment will be returned to the original purchaser transportation prepaid. If inspection of the equipment does not disclose any defect in material or workmanship, repairs will be made at a reasonable charge, which charges may include the costs of parts, labor, and transportation.

**THIS WARRANTY IS EXCLUSIVE, AND IS IN LIEU OF ANY OTHER WARRANTIES, EXPRESS OR IMPLIED, INCLUDING BUT NOT LIMITED TO WARRANTY OF MERCHANTABILITY OR WARRANTY OF FITNESS FOR A PARTICULAR PURPOSE.**

Graco's sole obligation and buyer's sole remedy for any breach of warranty shall be as set forth above. The buyer agrees that no other remedy (including, but not limited to, incidental or consequential damages for lost profits, lost sales, injury to person or property, or any other incidental or consequential loss) shall be available. Any action for breach of warranty must be brought within two (2) years of the date of sale.

Graco makes no warranty, and disclaims all implied warranties of merchantability and fitness for a particular purpose in connection with accessories, equipment, materials or components sold but not manufactured by Graco. These items sold, but not manufactured by Graco (such as electric motors, switches, hose, etc.), are subject to the warranty, if any, of their manufacturer. Graco will provide purchaser with reasonable assistance in making any claim for breach of these warranties.

In no event will Graco be liable for indirect, incidental, special or consequential damages resulting from Graco supplying equipment hereunder, or the furnishing, performance, or use of any products or other goods sold hereto, whether due to a breach of contract, breach of warranty, the negligence of Graco, or otherwise.

## **FOR GRACO CANADA CUSTOMERS**

The parties acknowledge that they have required that the present document, as well as all documents, notices and legal proceedings entered into, given or instituted pursuant hereto or relating directly or indirectly hereto, be drawn up in English. Les parties reconnaissent avoir convenu que la rédaction du présente document sera en Anglais, ainsi que tous documents, avis et procédures judiciaires exécutés, donnés ou intentés à la suite de ou en rapport, directement ou indirectement, avec les procédures concernées.

# Graco Information

**TO PLACE AN ORDER**, contact your Graco distributor, or call one of the following numbers to identify the distributor closest to you:

**1-800-533-9655 Toll Free**

**612-623-6928**

**612-378-3590 Fax**

*All written and visual data contained in this document reflect the latest product information available at the time of publication.  
Graco reserves the right to make changes at any time without notice.*

*This manual contains English. MM 309583*

**Graco Headquarters:** Minneapolis  
**International Offices:** Belgium, Korea, China, Japan

GRACO INC. P.O. BOX 1441 MINNEAPOLIS, MN 55440-1441

Copyright 2002, Graco Inc. is registered to I.S. EN ISO 9001

[www.graco.com](http://www.graco.com)

Revised 8/2008